

Din 7340 Tube Eyelets

Tube eyelets are manufactured from precision tube which give them a superior quality than conventional eyelets produced from sheet metal

Type of head:

- Type A (Flat)
- Type B (Round)
- Type C (Countersunk)

Material:

Standard material is Brass clean material can also be found in copper, steel, aluminium and stainless steel

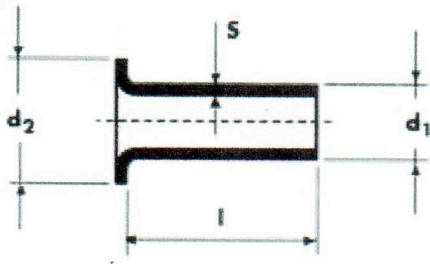

Type A: Flat Head

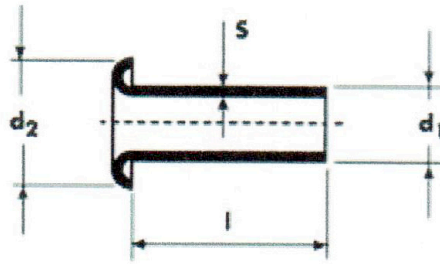

Type B: Round Head

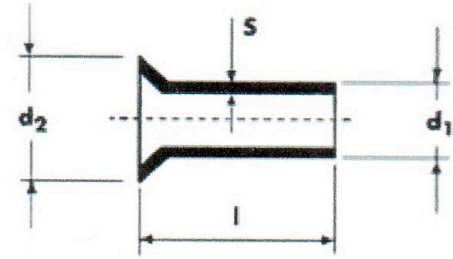

Type C: Countersunk Head

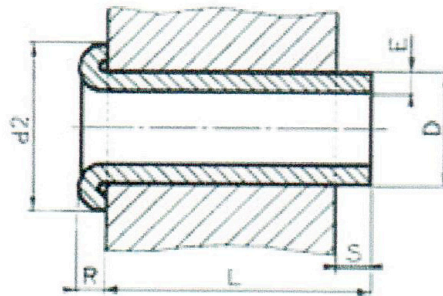

EYELET DIMENSIONS

D	1.2	1.5	2	2.5	3	3.5	4	4.5	5	5.5	6	8
Diameter d1 +/-	0.03	0.03	0.03	0.05	0.05	0.07	0.07	0.07	0.07	0.07	0.1	0.1
Int. Diameter +/- 0.10	0.8	1	1.4	1.9	2.4	2.9	3.2	3.7	4.1	4.5	5.14	7
Thickness E	0.2	0.25	0.3	0.3	0.3	0.3	0.4	0.4	0.45	0.5	0.43	0.5
Diameter d2	2	2.5	3.2	4	4.5	5.2	6	6.6	7.5	8.1	9	12
Tolerance on Diameter d2 +/-	0.15	0.20	0.20	0.20	0.20	0.30	0.30	0.30	0.30	0.30	0.30	0.30
Roll R.	0.25	0.30	0.40	0.40	0.50	0.50	0.60	0.60	0.70	0.80	0.90	1
Length S.	1	1.2	1.5	1.6	1.8	2.2	2.5	2.5	2.5	3	3.5	4.5
Length L. (min. max.)	1-15	1.5-40	2-60	2-60	3-100	3-120	3-120	3-80	3.80	4-80	4-80	4-80

Dimension in mm

TOLERANCE ON LENGTH

1 to 3 mm	3.5 to 6 mm	6.5 to 10 mm	10.5 to 20 mm	20.5 to 30 mm	30.5 to 60 mm	60.5 to 80 mm
+/- 0.12	+/-0.15	+/-0.18	+/-0.20	+/-0.25	+/-0.30	+/-0.35